

Count drawing's modified record with customer

Rev.	Revision content description	Date
V0	First issue	2017-09-07
V1	Change FPC length and BLU	2018-07-18
V2	变更背光, 增加凸台0.4mm	2020-03-24
V3	变更LCD+IC, (F3518+HX8357B), 并更改FPC	2021-04-14

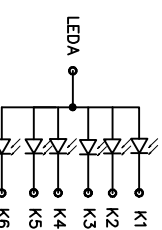
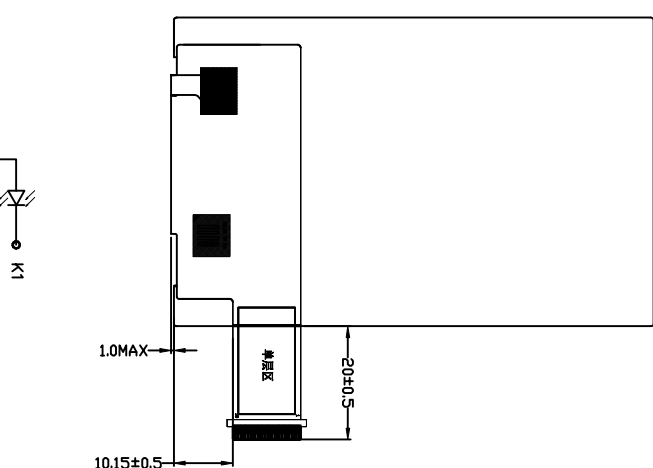
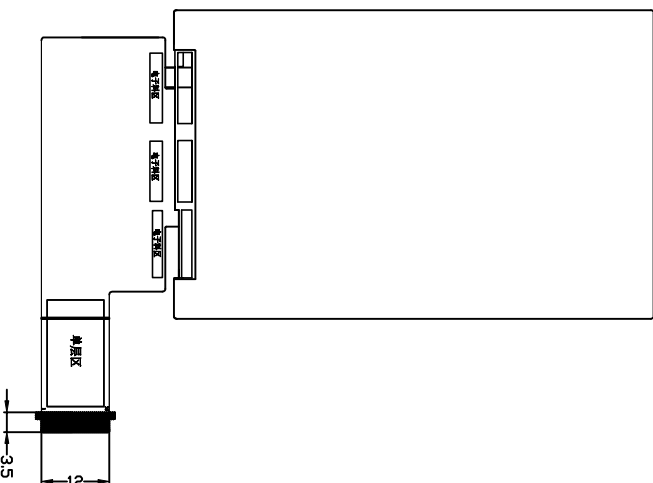
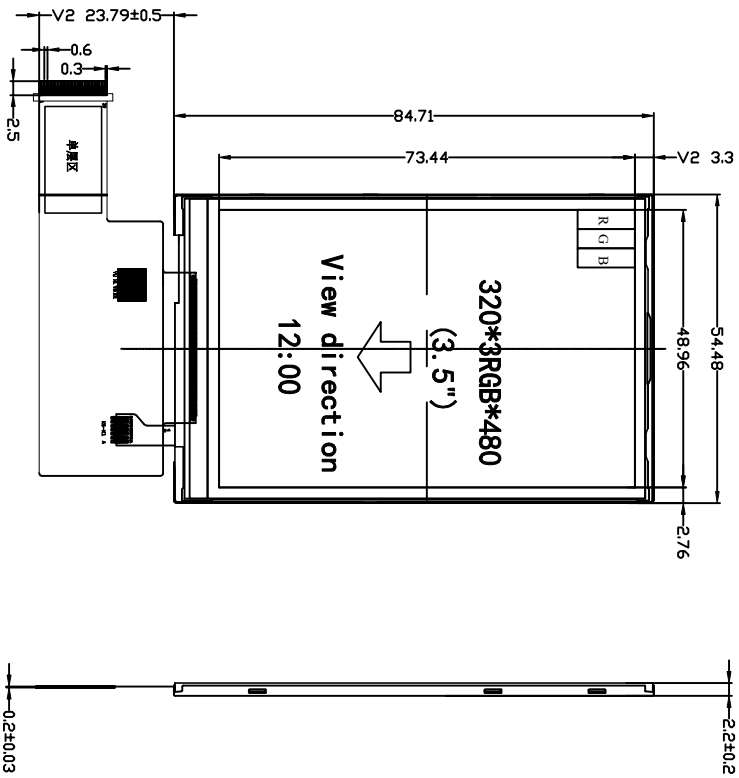

BACKLIGHT CIRCUIT DIAGRAM

NO.	SYMBOL
1	GND
2	YU
3	XR
4	YD
5	XL
6	FMARK
7	RESET
8	DB15
9	DB14
10	DB13
11	DB12
12	DB11
13	DB10
14	DB09
15	DB08
16	DB07
17	DB06
18	DB05
19	DB04
20	DB03
21	DB02
22	DB01
23	DB00
24	GND
25	RD
26	WR
27	RS
28	CS
29	T0VCC
30	VCC
31	LEDK6
32	LEDK5
33	LEDK4
34	LEDK3
35	LEDK2
36	LEDK1
37	LEDA
38	GND
39	NC

NOTES:

1. DISPLAY MODE:3.5" TFT LCD, Transmissive
2. DRIVER IC:HX8357B/ILI9488
3. VIEWING DIRECTION:12 O'CLOCK
4. BACKLIGHT:6 CHIP-WHITE LED, IF=90-120mA, VF=3.2V。
5. OPERATING TEMPERATURE:-20° C TO 70° C
6. GENERAL TOLERANCE:±0.20

TOLERANCE	SCALE	N.T.S
.X	±	mm
.XX	±	
	± 1°	

深圳市弘盛智能显示科技有限公司
 HONSEAN SHENZHEN HONSEAN SMART DISPLAY TECHNOLOGY CO.,LTD

DRG DATE	MODEL:
DRG BY: Welly	HS035CI39T13N-1LCM
APPROVED: jan	TITLE: